

How to Access BOOM Decks Purchased on Teachers Pay Teachers (TpT)

1.) Download your resource from TpT.

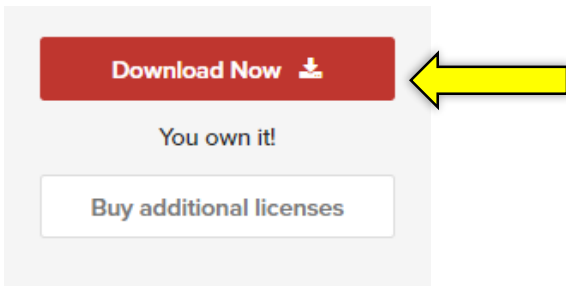

2.) Click on the resource picture on the first page of the download. This will take you to your deck on BOOM Learning.

RESOURCE ACCESS

CLICK HERE TO ACCESS YOUR BOOM DECK

A screenshot of a BOOM deck titled "MUSICAL SYMBOLS" with a "SUMMER THEME". Two yellow arrows point to the image.

After clicking, you will be prompted to sign in or sign up.

- If you already have a BOOM account, you will just need to sign in to access the deck.
- If you do not have an account, PLEASE click on the link on the NEXT PAGE. You will be taken to a doc that has instructions on how to set up your FREE account.

3.) Create a FREE Boom Learning Account. If you already have one, select Sign In.

Redeem Cards

Home Store Privacy FastPlay Sign In

Welcome! To redeem your purchase...

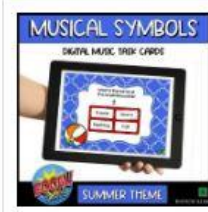

Musical Symbols- Summ...



by Band Directors Talk Shop

First, you need to create an account or log in

Create Sign-in

4.) Teacher Sign-Up (your choice on how you want to sign up) We set our account up with email.



5.) Click on “Yes, create account”

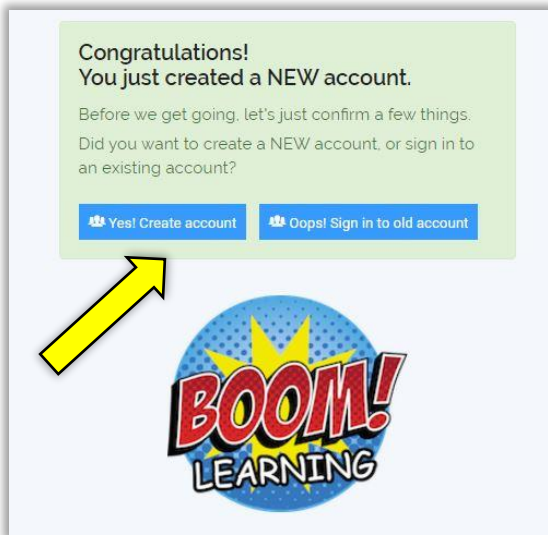

6.) To redeem your TpT purchase, click “Yes, that’s me!”

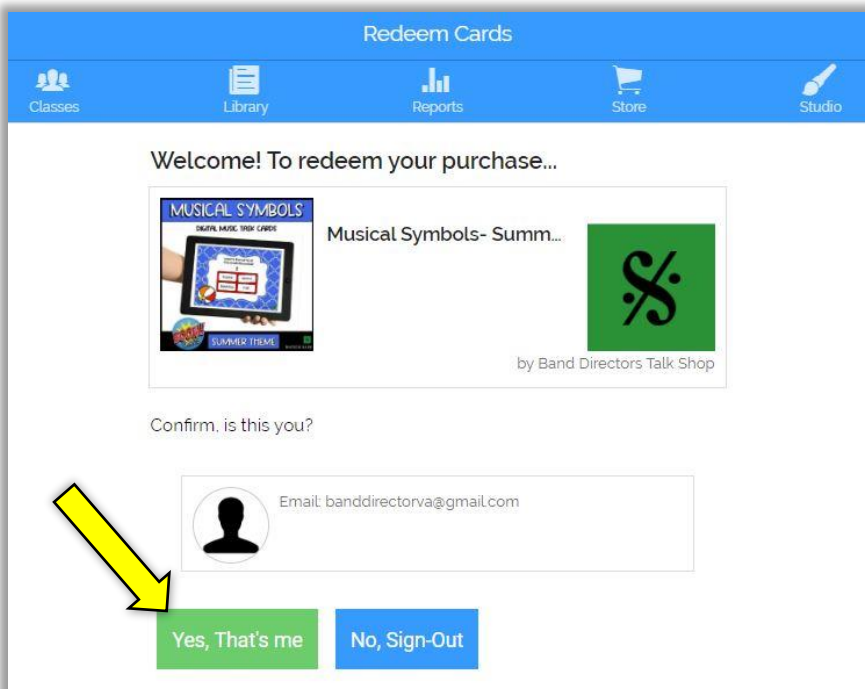

7.) Accept the terms and click the red "Redeem" button

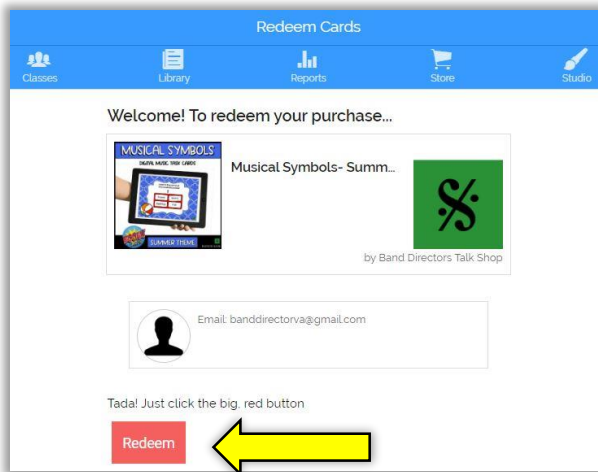

8.) Locate your Deck and click on the Action button. There, you will find FastPin!

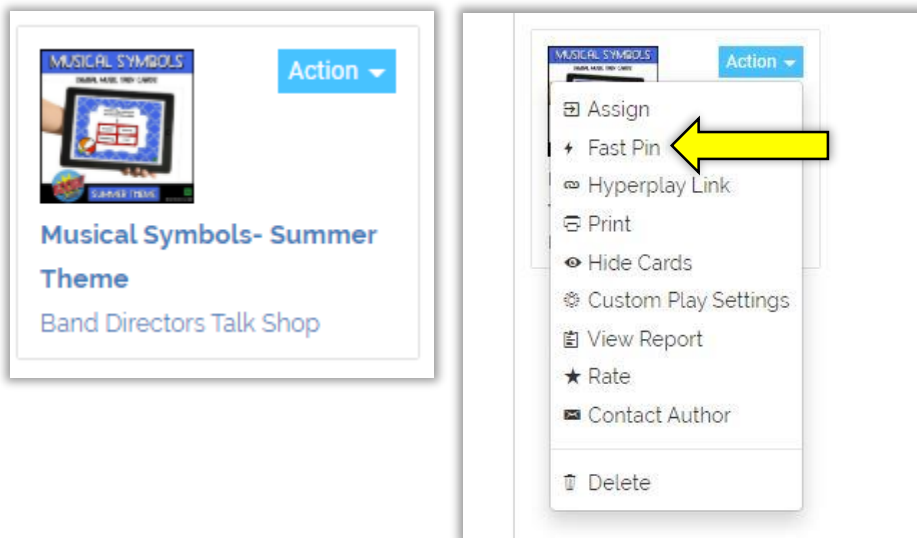

9.) Copy your FastPin link and paste into your google classroom. The link will be active for 14 days. If you choose to reassign the same deck, simply create a new FastPin. Remember- each FastPin you create will be active for 14 days but you can create new FastPins over and over.

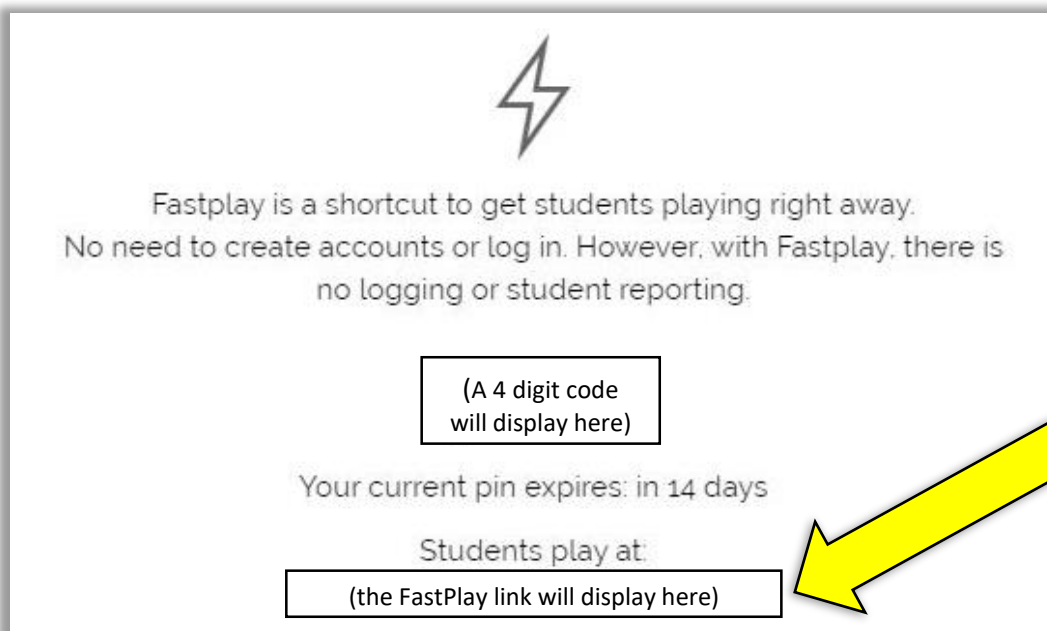

Share this link with students